

SKID PLATE KTM SX85/TC 85 2018

SOTTOMOTORE KTM SX 85/TC 85 2018

ACERBIS®

COD. 500005742

ACERBIS PARTS



A- (1 pcs.)

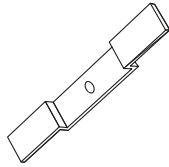

B- (1 pcs.)



C- (1 pcs.)



D- (1 pcs.)



E- (1 pcs.)



F- (1 pcs.)

1. Tagliare la spugna ed installarla seguendo misura e posizione indicate.

Cut the sponge to the above measurements and install it in the positions indicated.

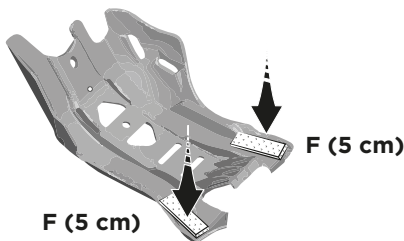

2. Assemblare la clip sulla staffa e posizionarla sul telaio. Posizionare il sottomotore e tenere la staffa con il dito come indicato nel disegno.

Assemble the clip on the bracket and place it on the frame. Place the skid plate and hold the bracket with the finger as indicated in the image.

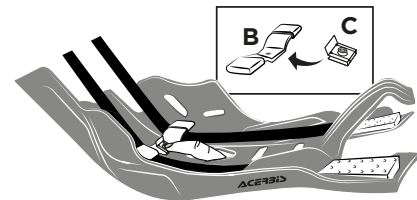

3. Avvitare il sottomotore al telaio tramite la vite in dotazione.

Screw the skid plate to the frame with supplied screw.

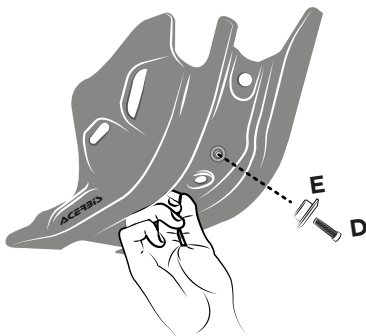

WARNING!

Use at your own risk. Check the security of your device before you ride. Be sure that you follow the instructions installing the Acerbis products. Do not ride if there is missing or damaged hardware. If this is the case, take the item immediately back to your dealer. Make sure the throttle and other controls are free every time you ride. Lack of attention to instruction and warning could lead to interference with the controls, loss of control, and an accidents. Acerbis recommends that installation must be done by a licensed mechanic and that only Acerbis original parts are used during fitting. Acerbis makes no guarantees or representations, express or implied, regarding the fitness of its products for any particular purpose. Acerbis makes no guarantees or representations, express or implied, regarding the extent to which its product protect individuals or property from injury or death or damage.